



## 11 Via Mare Cronulla NSW

3 2 2

Inspired by its sparkling ocean views and sought after South Cronulla address, this treasured family home of over 50 years presents an enriched lifestyle opportunity that will continue to delight for generations to come. Recently updated with revitalised floorboards and fresh paint, the abundance of natural light, refreshing sea breezes and flexible floorplan lies at the core of its design while the expansive interiors intertwine effortlessly with a choice of view enhanced balconies.

Boasting a desirable north-to-rear aspect and enviably located along the South Cronulla Peninsula with bus stop at the top of the street, just 150m to The Esplanade walkway, and 350m to iconic Shelly Beach, park and rock

[For full version visit the website](https://www.gibsonpartners.com/sale/nsw/sutherland/cronulla/residential/house/8155446)

**Type** : House  
**Price** : Auction (Unless Sold Prior)  
**Land Size** : 626 sqm  
**View** : <https://www.gibsonpartners.com/sale/nsw/sutherland/cronulla/residential/house/8155446>



**Ivan Lampret**  
02 9523 1333



**Karla Madgwick**  
02 9523 1333

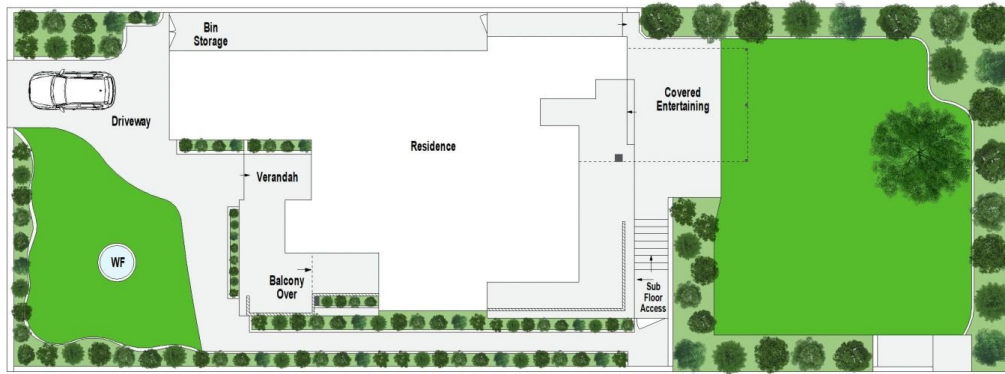

SITE PLAN (NOT TO SCALE)

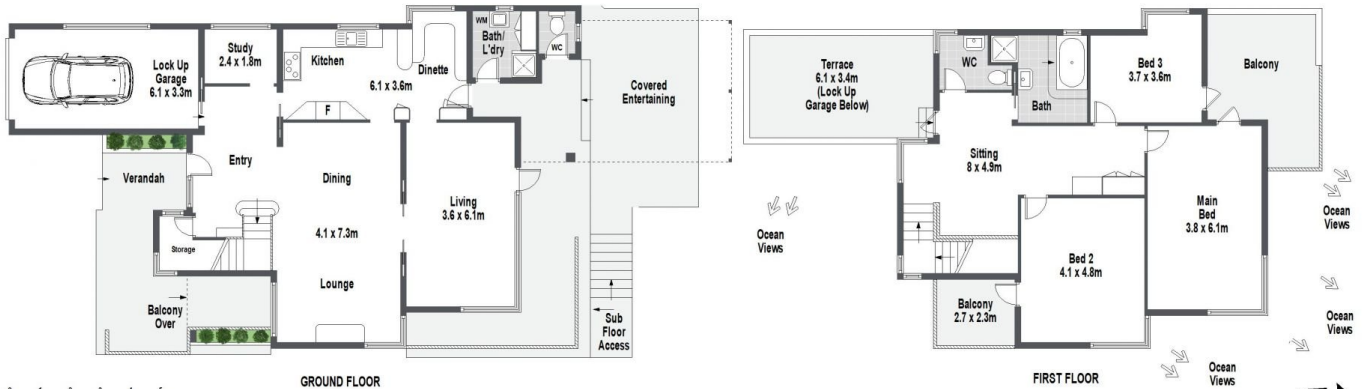

GROUND FLOOR

FIRST FLOOR

0 1 2 3 4 5 METRES  
Gibson Partners Real Estate Pty Ltd

**FLOOR PLAN** ON DEMAND Scale in metres. Indicative only. Dimensions are approximate. All information contained herein is gathered from sources we believe to be reliable. However we cannot guarantee its accuracy and interested persons should rely on their own enquiries.

11 Via Mare, Cronulla

**GIBSON**