



1/32-38 Evelyn Street North Sylvania NSW

3 2 2

Enjoying a private and peaceful setting in an exceptionally well-maintained boutique development of only six, this stately townhouse is instantly inviting. Thoughtfully designed to cater for all the demands of modern living yet offering the perfect place to unwind and relax in the spacious interiors that flow effortlessly to an entertainer's courtyard with lush established gardens.

Adding to the appeal is the quiet location and convenience to nearby bus stops, sporting grounds, restaurants, cafes, Holts Point Place Boat Ramp and Southgate Shopping Centre. An ideal choice for young families or those looking to downsize without compromising on space or ease of living.

[For full version visit the website](https://www.gibsonpartners.com/sale/nsw/sutherland/sylvania/residential/townhouse/8132895)

Type : Townhouse

Price : \$ 1,540,000

View : <https://www.gibsonpartners.com/sale/nsw/sutherland/sylvania/residential/townhouse/8132895>



Ivan Lampret
02 9523 1333



Karla Madgwick
02 9523 1333

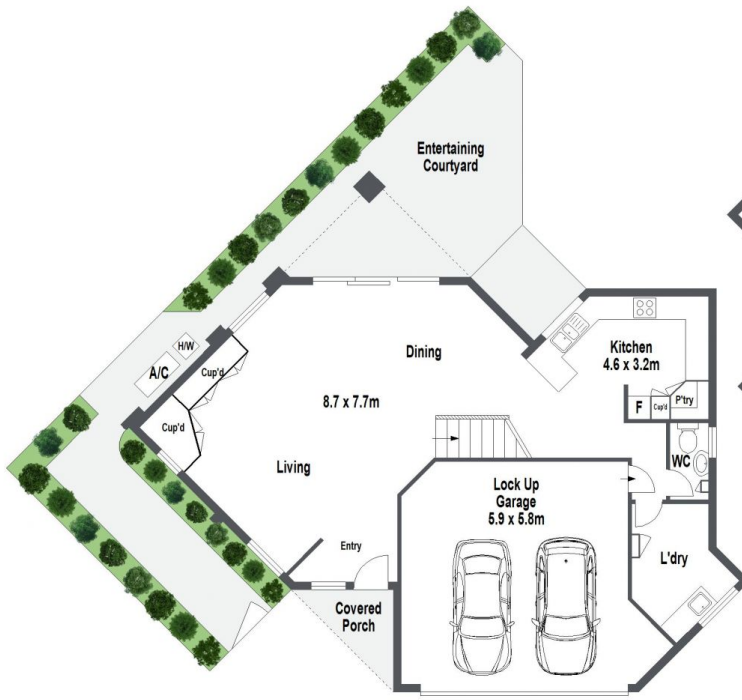

GROUND FLOOR



FIRST FLOOR

0 1 2 3 4 5 METRES.
Gibson Partners Real Estate Pty Ltd

FLOOR PLAN ON DEMAND Scale in metres. Indicative only. Dimensions are approximate. All information contained herein is gathered from sources we believe to be reliable. However we cannot guarantee its accuracy and interested persons should rely on their own enquiries.



1/32-38 Evelyn St N, Sylvania

GIBSON