



## 15 Horns Avenue Gymea Bay NSW

4 🛏 2 🚿 4 🚗

Ideally situated in a tranquil area of Gymea Bay, this beautiful home combines timeless charm with contemporary style. It boasts a private North-facing backyard with lush gardens and a sparkling inground pool, offering a perfect retreat for families. Ideally located within walking distance to schools, bus stops, Gymea Village shops, picturesque waterways, and vibrant cafes, this home provides both tranquillity and convenience.

- Expansive dual-level layout with multiple living and entertaining areas
- Contemporary kitchen with ample cupboard space and island bench
- Four bedrooms, main bedroom features a walk-in-robe and ensuite
- Luxurious main bathroom with deep tub, laundry with

**Price** : \$1700 per week

**View** : <https://www.gibsonpartners.com/lease/nsw/sutherland/gymea-bay/residential/house/8108160>



**Emily Musumeci**  
02 9523 1333



**Chris Malliate**  
02 9523 1333



GROUND FLOOR



LEVEL 1

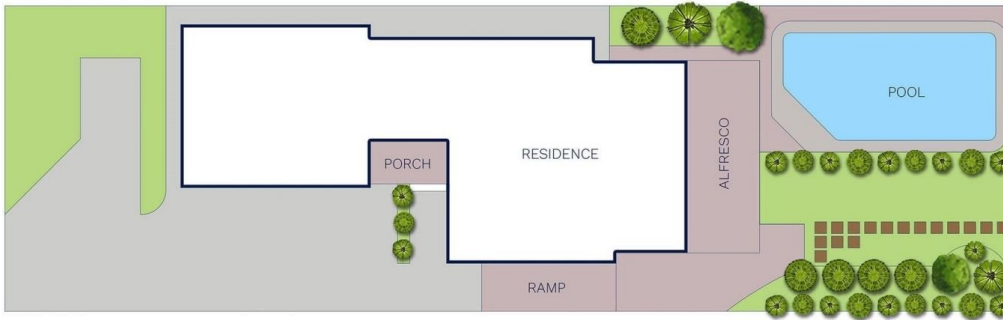

Scale in Metres. Indicative only. Dimensions are approximate. All information herein is gathered from sources we believe to be reliable, however we cannot guarantee their reliability and interested persons should rely on their own inquiries.

**15 Horns Avenue, Gymea Bay**