



38A Grosvenor Crescent Cronulla NSW

3 2 2

Offering panoramic vistas of the Port Hacking River and Gunnamatta Bay, this exceptional family home is characterized by its flawless interiors and generous space, achieving a perfect harmony between indoor and outdoor entertainment areas for contemporary family life.

At the water's edge, the experience is enhanced with access to an inground swimming pool and outstanding amenities including a private jetty and covered alfresco area. Ideally positioned near schools, shops, and offering effortless access to all that Cronulla has to offer, this residence embodies the epitome of waterfront living.

- Recently completed, immaculate waterfront home
- Herringbone flooring throughout open plan living areas
- Contemporary kitchen and main bathroom with bathtub

Price : \$2450 per week

View : <https://www.gibsonpartners.com/lease/nsw/sutherland/cronulla/residential/semi-detached/8080059>



Chris Malliate
02 9523 1333



Nicholas Di Martino
02 9523 1333

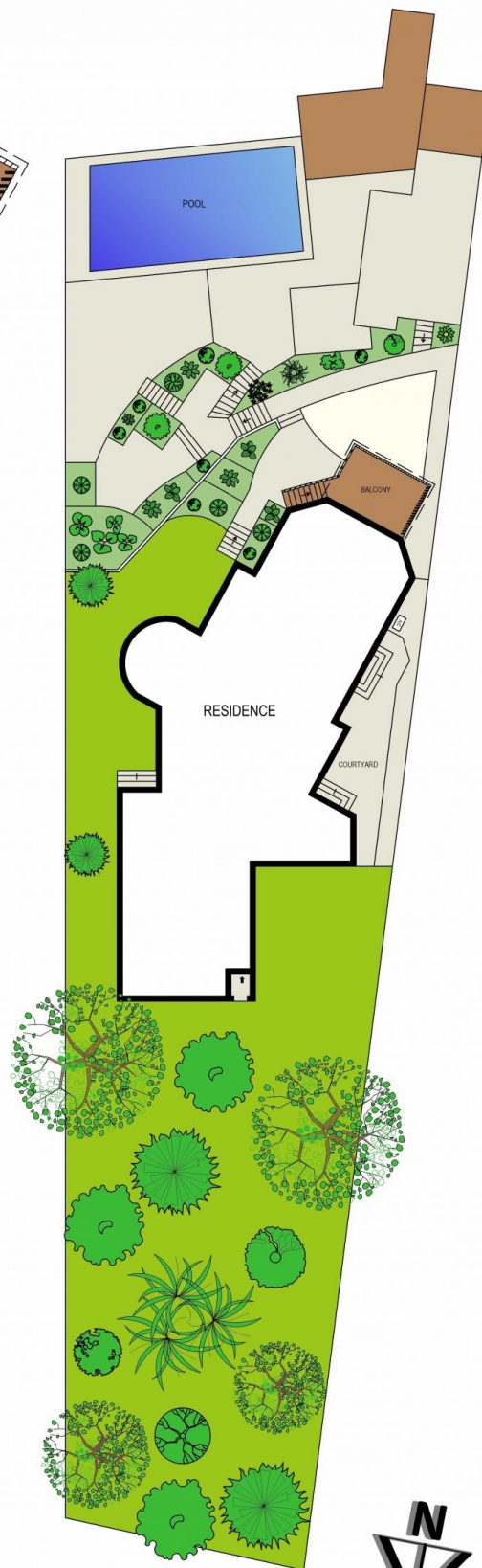

ADDRESS:
38A Grosvenor Crescent, Cronulla

DISCLAIMER: THIS IS FOR ILLUSTRATIVE PURPOSES ONLY, ALL DIMENSIONS ARE APPROXIMATE AND IT DOES NOT CONSTITUTE PART OF ANY LEGAL DOCUMENTS.