



21 Terrace Avenue Sylvania NSW

2 1 1

Perfectly positioned on the high side of the street and capturing impressive district views of Sylvania Waters, Kurnell and Miranda, this charming and beautifully maintained two bedroom cottage showcases all the characteristics of a classic 1950's home offered for the first time in over 70 years.

Price : \$ 2,005,000
Land Size : 645 sqm
View : <https://www.gibsonpartners.com/sale/nsw/sutherland/sylvania/residential/house/6746135>

Ideally suited to buyers looking to secure an R2 Low Density Residential block to capitalise on in the future with a new home or development (STCA).

Conveniently located within approximately 400m to Sylvania Heights Public School, 1km drive to Southgate Shopping Centre and a 3km drive to Westfield Miranda shopping, dining & entertainment.



Chris Walsh
02 9523 1333

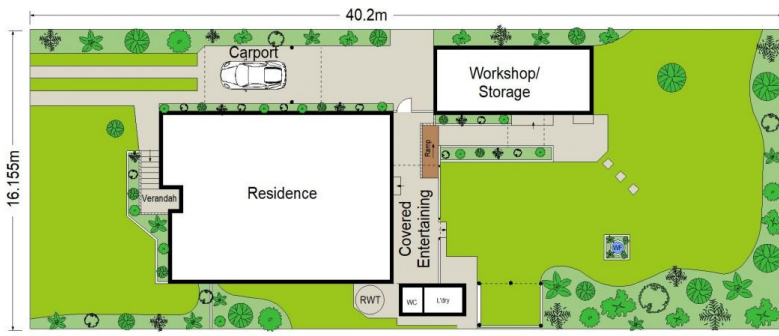

SITE PLAN (NOT TO SCALE)

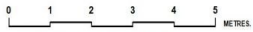

Gibson Partners Real Estate Pty Ltd

Scale in metres. Indicative only. Dimensions are approximate. All information contained herein is gathered from sources we believe to be reliable. However we cannot guarantee its accuracy and interested persons should rely on their own enquiries.



21 Terrace Avenue, Sylvania

GIBSON