



## 64 Parthenia Street Dolans Bay NSW

6 3 4

Presenting an unbelievable opportunity to embrace waterfront living from this prime 1208sqm (approx.) boasting breathtaking views over Dolans Bay and The Port Hacking River. Affording immense comfort and versatility, the current home offers plenty of accommodation and is currently split into 3 separate self-contained spaces, that can be easily re-created into a spacious family dream home.

Epitomising an elevated peninsula position close to Dolans Bay Marina, local schools, shops, parks and transport, this property will suit those looking for a solid family home with potential to add their own personal touch relish in its sublime waterfront setting.

- Breathtaking Dolans Bay views embraced from each level

**Land Size** : 1208 sqm

**View** : <https://www.gibsonpartners.com/sale/nsw/utherland/dolans-bay/residential/house/5855132>



**Ivan Lampret**  
02 9523 1333



**Farrah Tidmarsh**  
02 9523 1333

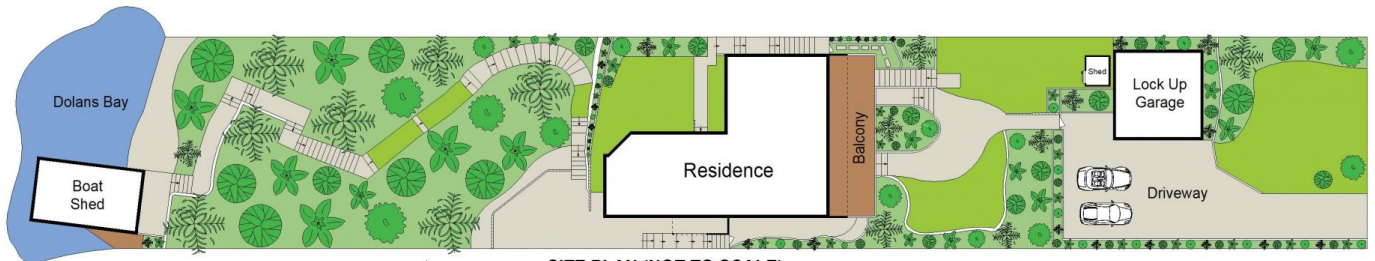

**SITE PLAN (NOT TO SCALE)**



0 1 2 3 4 5 METRES

Gibson Partners Real Estate Pty Ltd

Scale in metres. Indicative only. Dimensions are approximate. All information contained herein is gathered from sources we believe to be reliable. However we cannot guarantee its accuracy and interested persons should rely on their own enquiries.



64 Parthenia Street, Dolans Bay

**GIBSON**