



2/25 Bando Road CRONULLA NSW

3 2 2

Lifestyle - Full brick construction and in a small boutique development of only 3, this wonderful townhouse is sensational in size and design and is a short stroll to the beach and the cronulla cafe lifestyle

Accommodation - 3 generous bedrooms, master with en suite, Formal lounge, separate dining room plus separate study area , spacious modern dishwasher kitchen , private sun drenched garden which adjoins the double garage with sliding doors that also allows extra entertaining areas.

Features - double garage ,Laundry with 3rd toilet, ample storage. Strata rates \$557 per quarter approx. Townhouse size approx. 208m2. (Including garage)

Building Size : 22 sqm
View : <https://www.gibsonpartners.com/sale/nsw/sutherland/cronulla/residential/townhouse/5854824>



Denise Howell
02 9523 1333

Cronulla

2/25 Bando Road



Ground Floor

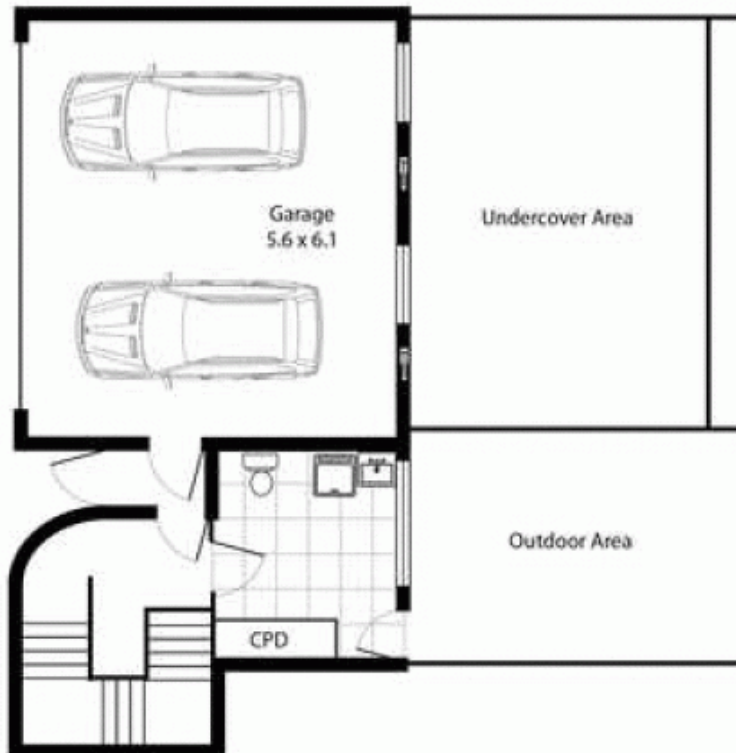

Please note: all stated dimensions are approximate only. Particulars given are for general information only and do not constitute any representation on the part of the vendor or agent.