



## 5 Alfred Avenue Cronulla NSW

3 2 2

An exceptional contemporary design defines this luxurious brand new duplex that has been expertly constructed with premium finishes and inclusions to complement the sleek and streamlined aesthetics. Magnificent in both proportion and appeal this glorious haven is flooded with natural light from its rear northerly aspect. Featuring engineered American Oak flooring, keyless entry, vaulted ceilings, custom cabinetry and ample storage throughout.

Showcasing a fabulous family-friendly layout with undercover alfresco entertaining, this exceptional designer home provides the ultimate coastal lifestyle and is conveniently located within a leisurely stroll to Cronulla Golf Course, schools and Cronulla's superb beaches.

- North facing luxury open plan living with American Oak

**Price** : \$ 1,765,000

**View** : <https://www.gibsonpartners.com/sale/nsw/sutherland/cronulla/residential/house/5853912>



**Ivan Lampret**  
02 9523 1333

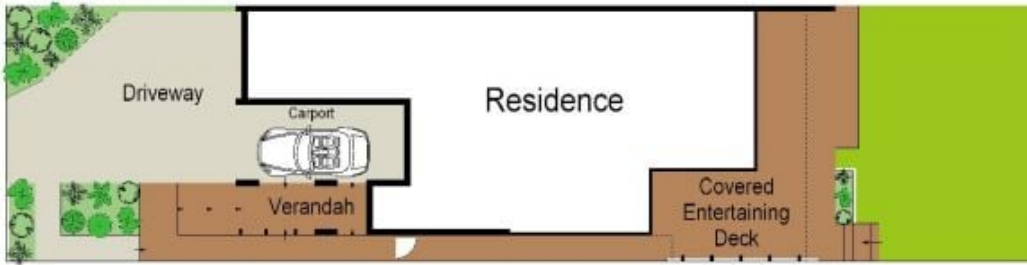

SITE PLAN (NOT TO SCALE)

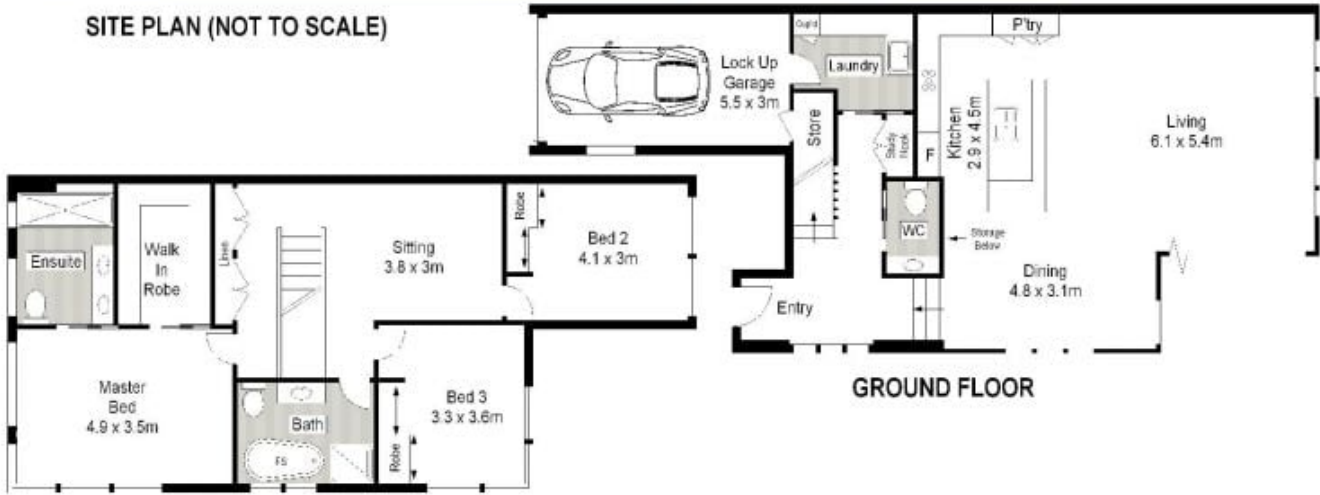

GROUND FLOOR

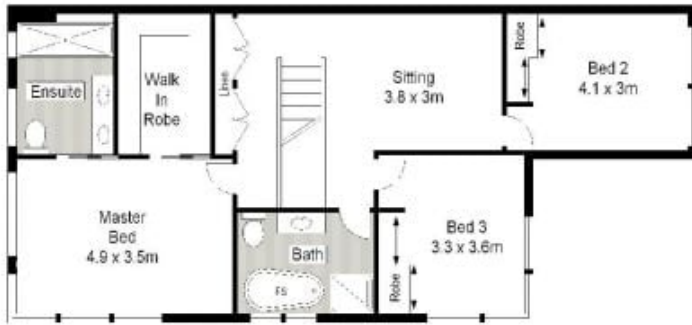

FIRST FLOOR



Gibson Partners Real Estate Pty Ltd

Scale: All measures indicated are only approximate and do not constitute a contract. All information contained herein is provided for general information only and does not constitute an offer of any financial product. All measures are approximate and do not constitute a contract. All measures are approximate and do not constitute a contract.



5 Alfred Avenue, Cronulla

**GIBSON**