

4/55 Kingsway Cronulla NSW

2 1 1

Conveniently positioned, this north east facing apartment presents a fantastic opportunity and a must see for the first home buyer or investor looking to enter the Cronulla real estate market.

Price : \$ 553,000

View : <https://www.gibsonpartners.com/sale/nsw/sutherland/cronulla/residential/apartment/5853799>

Situated on the first floor of a well maintained security block, this great 2 bedroom apartment with open plan living, offers all the convenience of living in the cosmopolitan suburb of Cronulla, walking distance to Cronulla Beach, Mall, restaurants and transport.

- Ideal for buyers looking for walk to everywhere convenience
- Open plan living leading onto north east facing balcony
- Separate kitchen with adjoining laundry with good storage
- 2 generous bedrooms with built in robes



Ivan Lampret
02 9523 1333



Karla Madgwick
02 9523 1333

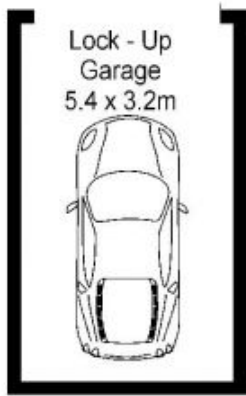

GROUND FLOOR

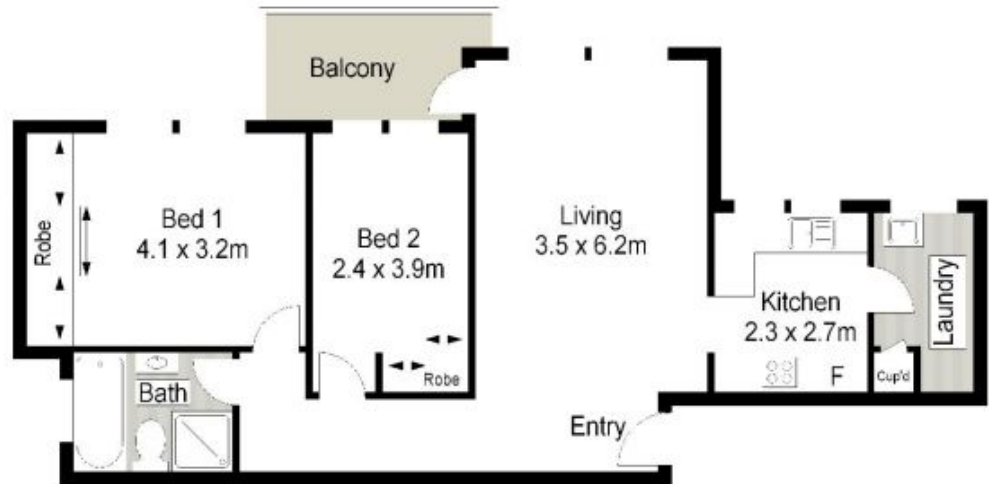

FIRST FLOOR



SCALE IN METERS.

Gibson Partners Real Estate Pty Ltd

Scale is approximate. Indicated only. Dimensions are approximate. All information contained herein is for general information only and does not constitute a contract. All information is provided for general information only. Information presented is for general information only. Information presented is for general information only. Information presented is for general information only.



4/55 Kingsway, Cronulla

GIBSON