



## 6 Beach Street Cronulla NSW

3 2 2

Looking out from both levels of this solid family residence, the rolling surf of Sandshoes seems almost close enough to touch. Situated on a sizeable 948.5sqm level block with direct rear gate access to Oak Park this prime position is often sought, but rarely available. This immaculately maintained home offers a generous layout with multiple living areas, superb gardens and a spectacular view over Oak Park towards Jibbon Point.

Within footsteps of your back door you can enjoy a surf, paddle, swim or Esplanade walk while the kids will embrace the wide open spaces of the recently upgraded park. This property is all about location and will suit families seeking an enviable beachside lifestyle.

\* Huge 948.5sqm block, 20 metre frontage & backing onto

**Land Size** : 948.5 sqm

**View** : <https://www.gibsonpartners.com/sale/nsw/sutherland/cronulla/residential/house/5853501>



**Ivan Lampret**  
02 9523 1333



**Karla Madgwick**  
02 9523 1333

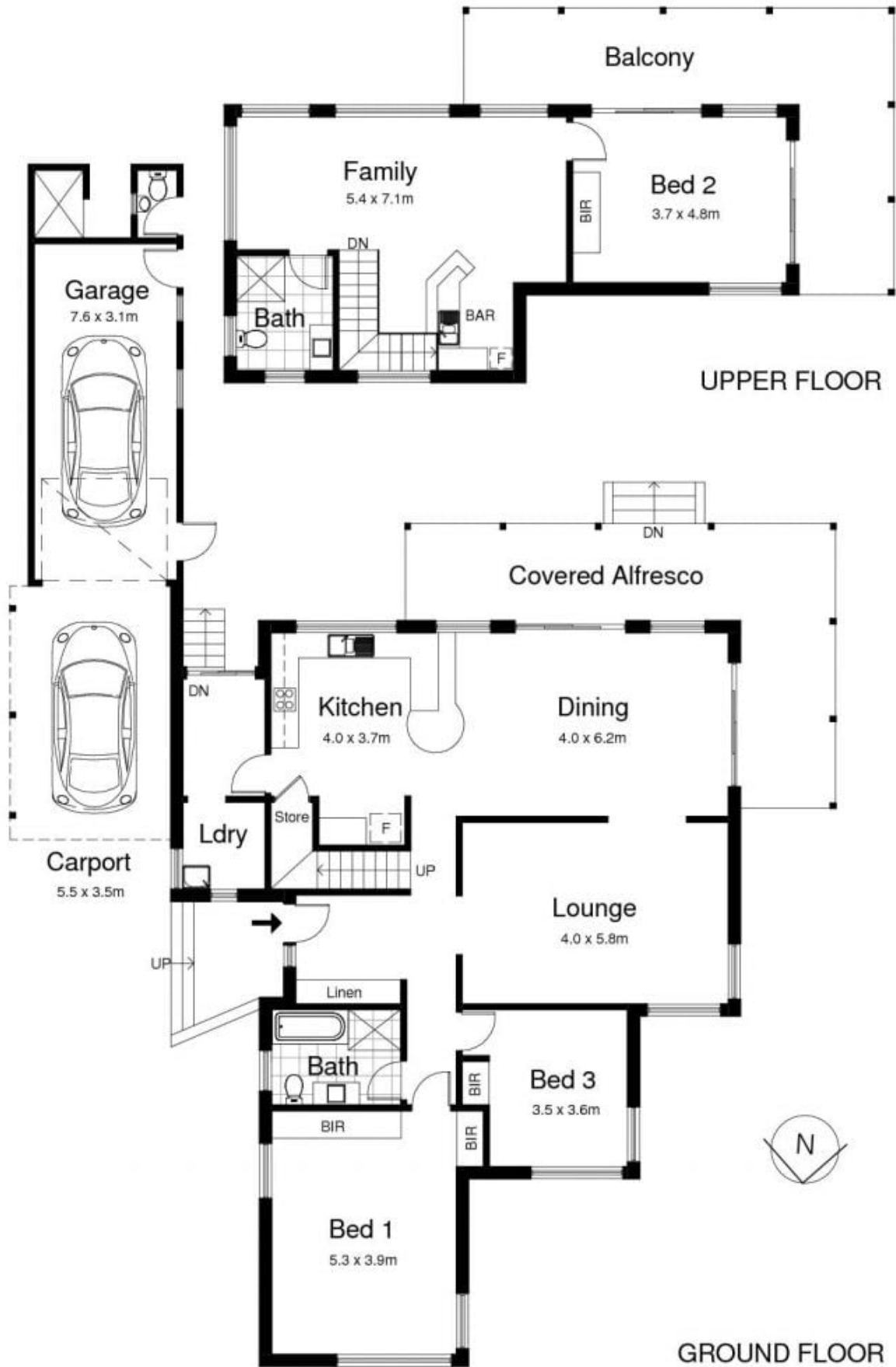

## 6 Beach Street, CRONULLA

DISCLAIMER: All care has been taken in preparing this floorplan, however the accuracy is not guaranteed and no liability will be accepted for any reliance placed upon it  
 Produced by PRODUCT PHOTOGRAPHY STUDIO mob: 0414 697 215 email: mgphoto@people.net.au