



16 Cumbee Lane Caringbah South NSW

4 🏠 2 🚗 4 🚗

Spectacular deep waterfront residence enjoying breathtaking panoramic views over Burraneer Bay, Dolans Bay and Maianbar with an easy level entry to the house.

This sensational dual level architect designed contemporary residence is situated in a quiet cul de sac with a sought after street to waterfront position and has fabulous water facilities.

Offering an ultra modern design with a focus on space, style, light & views, it is ideal for a relaxed family lifestyle.

- Easy access to the waterfront
- Gated security
- Four car garaging
- Home office or 5th bedroom
- Beech/granite kitchen
- Formal & casual entertaining

View : <https://www.gibsonpartners.com/sale/nsw/sutherland/caringbah-south/residential/house/5853337>

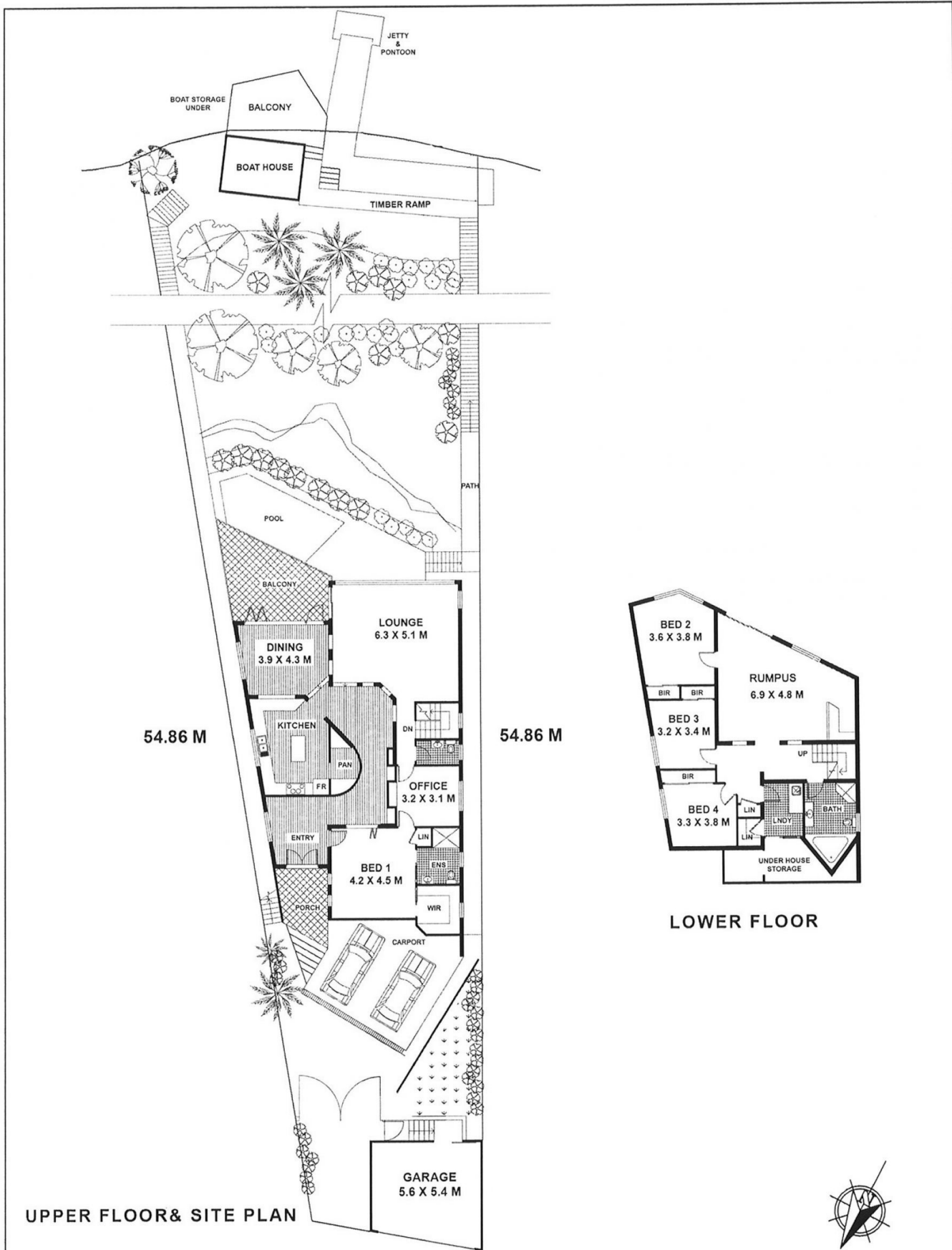

UPPER FLOOR & SITE PLAN

LOWER FLOOR



**No. 16 CUMBEE LANE,
CARINGBAH**

DISCLAIMER : All care has been taken in preparing this floor plan, however the accuracy is not guaranteed and no liability will be accepted for any reliance placed upon it.
Produced by PRODUCT PHOTOGRAPHY STUDIO
mob: 0414 697 215 e: mgphoto@people.net.au