



2/7-11 Searl Road CRONULLA NSW

2 1 2

Jason Monk of Gibson Partners PROUDLY MARKETS..... Promoting a relaxed and casual lifestyle, this light filled garden apartment is very private and secure. With a spacious single level design, extra large open plan living area, 2 entertainers courtyards and positioned in Cronulla's most convenient locations only foot steps to the water's edge of Gunnamatta Bay and marina.

View : <https://www.gibsonpartners.com/sale/nsw/sutherland/cronulla/residential/apartment/5853265>

- * Private garden apartment
- * 2 generous bedrooms
- * Huge open plan lounge and dining area
- * 2 generous courtyards for entertaining
- * Luxury kitchen with stone tops and gas cooking
- * Gas heating and split system air conditioning
- * Extra large double garage in security basement
- * Ultra modern stylish development

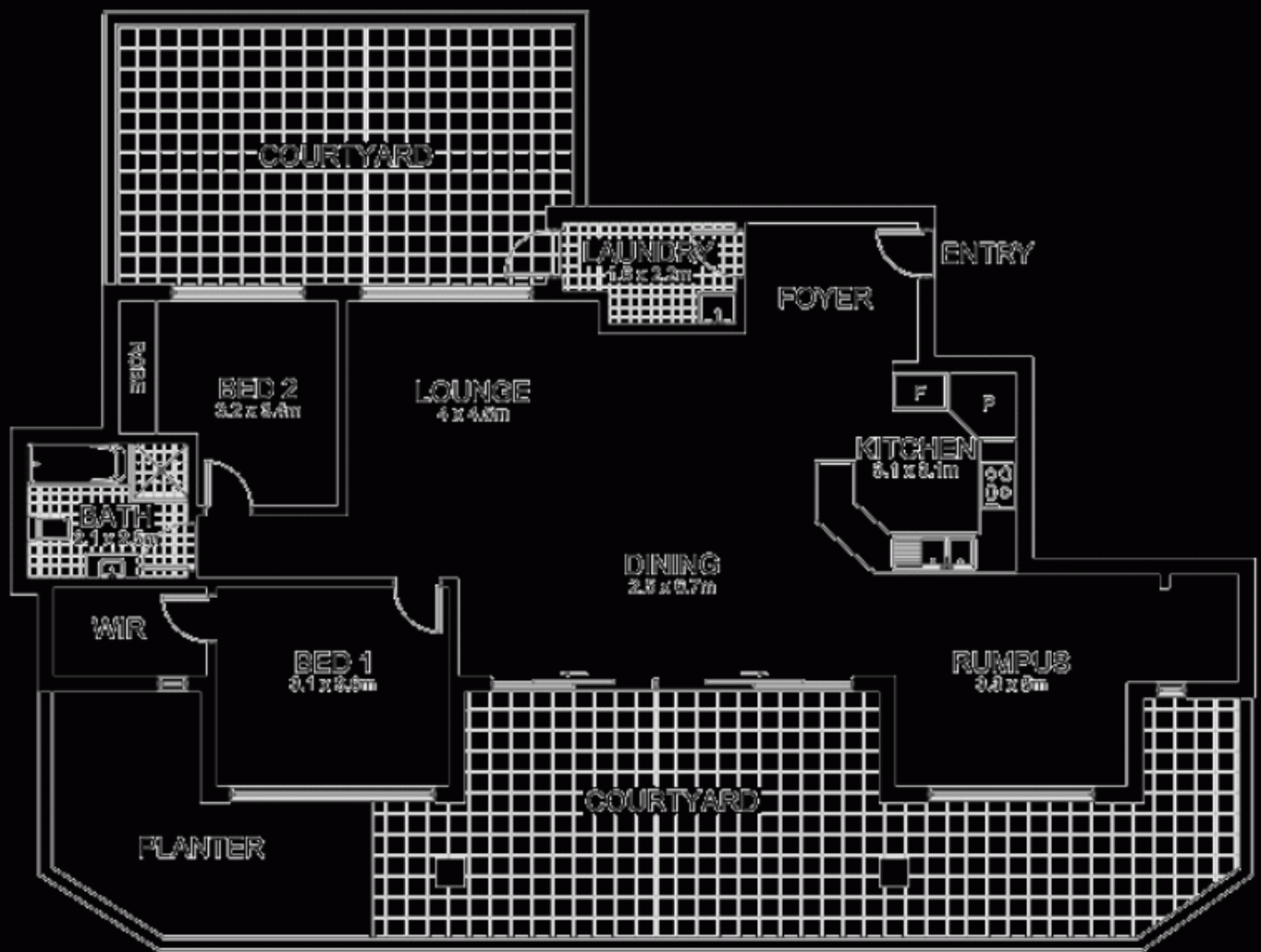

27-11 SEAL ROAD,
CRONULLA

DISCLAIMER: All care has been taken in preparing this floor plan, however the accuracy is not guaranteed and no liability will be accepted for any reliance placed upon it.

Produced by PRODUCT PHOTOGRAPHY STUDIOS
 mobile: 0414 637 218 email: ruphoto@optusnet.au