



35 Immarna Avenue LILLI PILLI NSW

4 🏠 2 🚗 2 🚗

Privately set in a prestige pocket of Lilli Pilli, this west facing street-to-water deep waterfront home offers magical views over The Port Hacking River across to The Royal National Park while offering extreme privacy and serenity.

View : <https://www.gibsonpartners.com/sale/nsw/sutherland/lilli-pilli/residential/house/5853188>

Of brick construction and bathed in sunshine, the home is elevated sufficiently to give an expansive view yet close enough to be part of the family activity on the huge level lawns, in-ground pool and deep water front facilities boat shed & ramp, jetty & pontoon.

Sure to make a lasting impression, the home offers a layout suitable for the growing family featuring plenty of entertaining options, yet also has the potential to be renovated and imaginatively transformed into an exceptionally detailed contemporary dream home.



Ivan Lampret
02 9523 1333

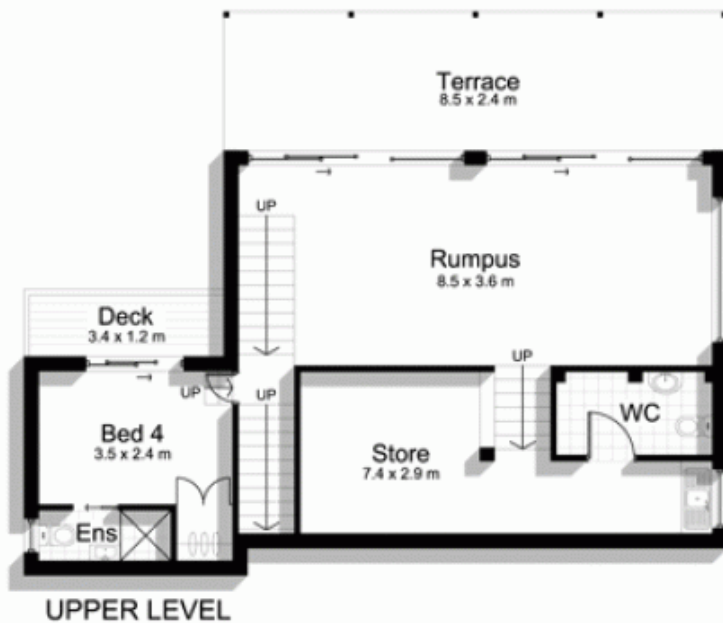

**35 Immarna Avenue,
LILLI PILLI**

DISCLAIMER: All care has been taken in preparing this floor plan, however the accuracy is not guaranteed and no liability will be accepted for any reliance placed upon it
Produced by PRODUCT PHOTOGRAPHY STUDIO
mob: 0414 697 215 email: mgphoto@people.net.au