





## 19 Sturt Road CRONULLA NSW

3  2  2 

Jason Monk of Gibson Partners Real Estate PROUDLY MARKETS..... 'Bembrook', With dramatic golf course views and a commercial tennis court, this immaculately presented family residence has been designed over 2 easy living levels and flooded with natural sunlight. With multiple living zones, large open plan kitchen and an extensive sun drenched terrace for entertaining.

**View** : <https://www.gibsonpartners.com/sale/nsw/sutherland/cronulla/residential/house/5853018>

Referred to as the 'Country Club', by family and friends, this unique property is ideally suited to all family styles and absolute lovers of tennis or golf and ideally positioned within moments to Schools, shops and beaches.

- \* Extra large living area extends to expansive entertainers terrace
- \* Polished hardwood timber flooring

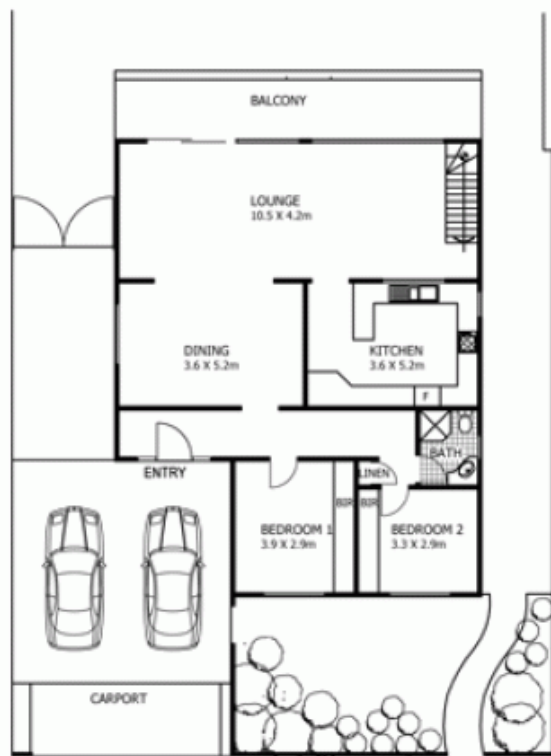

**FIRST FLOOR PLAN**

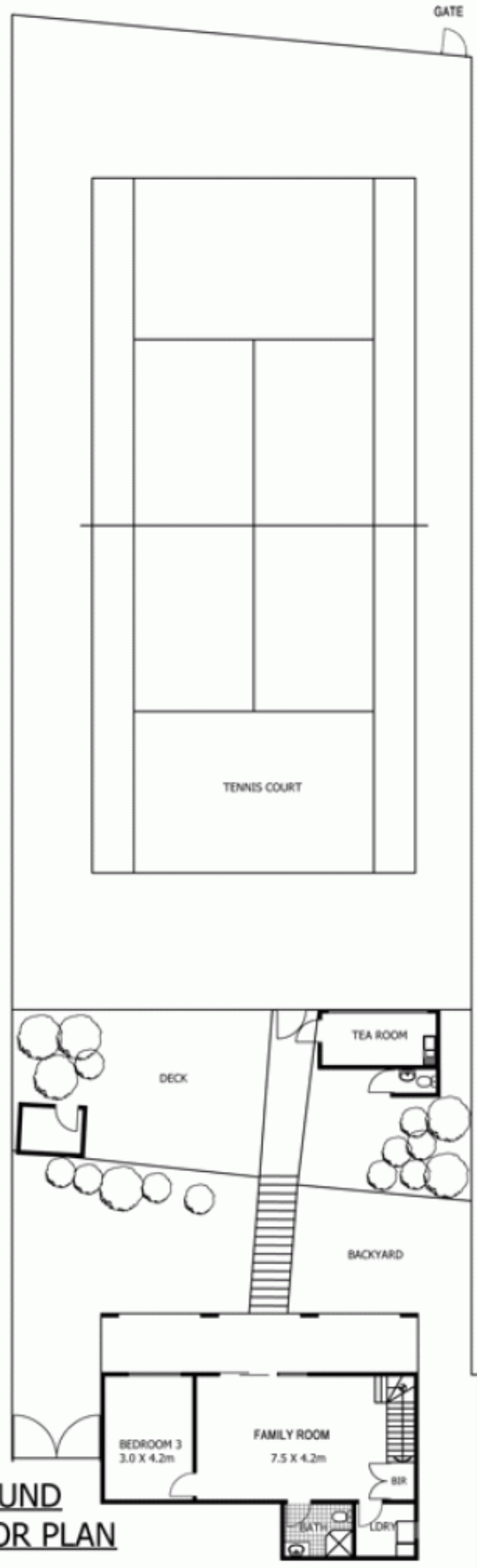

**GROUND FLOOR PLAN**

**19 STURT RD  
CRONULLA**

DISCLAIMER: All care has been taken in preparing this floor plan, however the accuracy is not guaranteed and no liability will be accepted for any reliance placed upon it  
Produced by PRODUCT PHOTOGRAPHY STUDIO  
mob: 0414 697 215 email: mgphoto@people.net.au