

## 359A Willarong Road Caringbah South NSW

7 🏠 5 🚗 4 🚘

Soaking up sublime water views over Yowie Bay, this tri level deep water front is only 9 years old and simply a breath taking home of unquestionable size and substance.

Embraced by approx. 1187sqm of prime real estate, its desirable north-westerly orientation ensures all-day sun while enjoying a leisurely waterside lifestyle with private sandy beach, double boatshed with slip way, jetty & pontoon.

Secluded from the street, it affords the total privacy demanded by discrete buyers yet offers plenty of flexibility in accommodation for the extended family or those searching for options of self-contained accommodation.

\* Water views can be enjoyed from almost every room in

**Land Size** : 1187 sqm

**View** : <https://www.gibsonpartners.com/sale/nsw/sutherland/caringbah-south/residential/house/5852145>



**Ivan Lampret**  
02 9523 1333

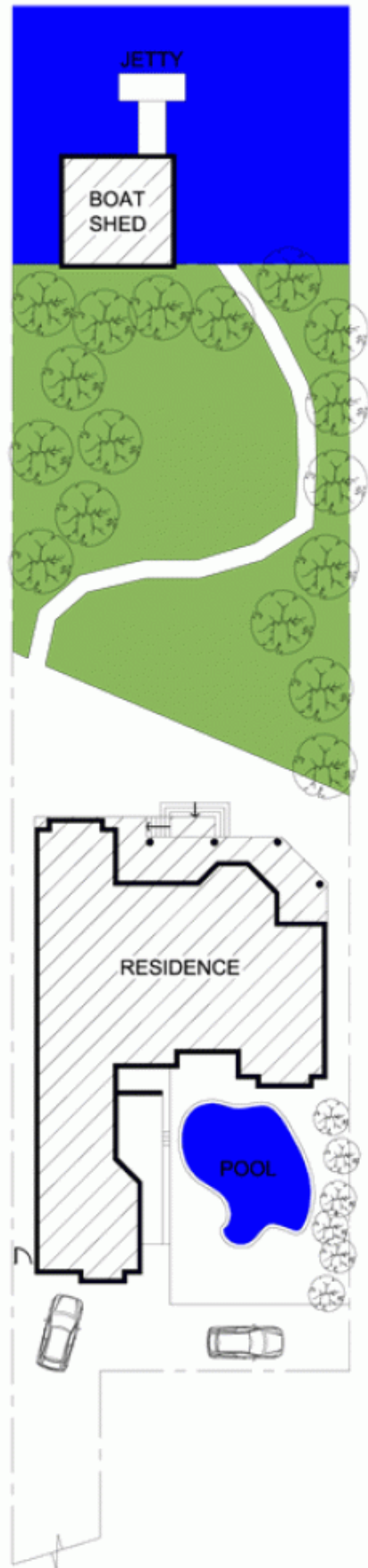

359a Willarong Road,  
CARINGBAH

DISCLAIMER: All care has been taken in preparing this floor plan, however the accuracy is not guaranteed and no liability will be accepted for any reliance placed upon it  
Produced by PRODUCT PHOTOGRAPHY STUDIO  
mob: 0414 697 215 email: mgphoto@people.net.au